



PREMIUM E-MOBILITY



www.globalyadea.com

<https://www.motomanuals.net/>

FOREWORD

Dear customers:

First of all, thank you for choosing to buy "YADEA" products.

This manual introduced the knowledge and maintenance methods of electric scooter, please read the manual carefully to understand the scooter performance, characteristics, attention tips and maintenance knowledge, give full play to the advantages of "YADEA" electric scooter to ensure safe driving in the best driving state.

For effective protection of this scooter, please be sure to use "original parts for YADEA products". If you have any questions, please contact our authorized service station or our company.

First maintenance time: one month after buy the scooter.

Next maintenance time: three months after last maintenance.

CONTENTS

General Notice
Precautions
Safety Notice
Parts Info
Operation Guide
Battery & charger Use and Maintenance
DOs and DON'Ts while Riding
Maintenance and Repair
Troubleshooting List
Technical Parameters
Maintenance Record

General Notice

- ▶ Please read this User Manual carefully for proper operation before riding the scooter.
- ▶ For your safety, please check whether the parts are in good condition according to this User Manual before riding. Contact your dealer in time in case of any problems.
- ▶ Please follow the traffic laws. Slow down on slippery roads in bad weather to allow greater braking distance for your safety.
- ▶ Please pay attention to deep water. It may cause rusting or failure of the motor, battery or other parts if water level reaches wheel axle.
- ▶ Do not dismantle the scooter on your own. Please contact your dealer for replacement or purchase of original parts.
- ▶ Do not lend your scooter to those who can't operate a scooter for others' safety and preventing unnecessary damage to your scooter.
- ▶ Please keep this User Manual properly.

2

Precautions

Rider and Passenger

G5 is not designed for a ride of more than 2 persons. Riding 0

G5 is not designed for off-road use.

This User Manual should be deemed as a permanent docume

to others, this User Manual should also be handed over to the

Reproduction or reprint of any part of this User Manual is stri

Warning: Failure to follow the instructions herein may lead to

Attention: Failure to follow the instructions herein may lead to

Safety Notice

- ▶ Using a safety helmet and protective goggles is strongly advised.
- ▶ You are advised to take proper training or exercise before using on open roads.
- ▶ Please follow the Operation Guide to fully understand how to properly operate the scooter.

It should be noted that the braking distance in bad weather will be much longer.

Please avoid braking on paint markers, manhole covers and oil stains to prevent slipping.

Pay extra attention when riding through railway crossings, junctions, tunnels, and bridges.

Slow down if road conditions are unclear.

Do not use high beam indiscriminately. Continuous use of high beam will cause discomfort of the drivers and pedestrians.

Do not use mobile phones or other electronic devices which may distract your attention.

Do not change the lane without signaling. Changing the lane at the last moment is dangerous.

When you need to change the lane, remember to switch on the turn signal in advance.

Check the vehicles approaching from behind before changing the lane.

Parts Info

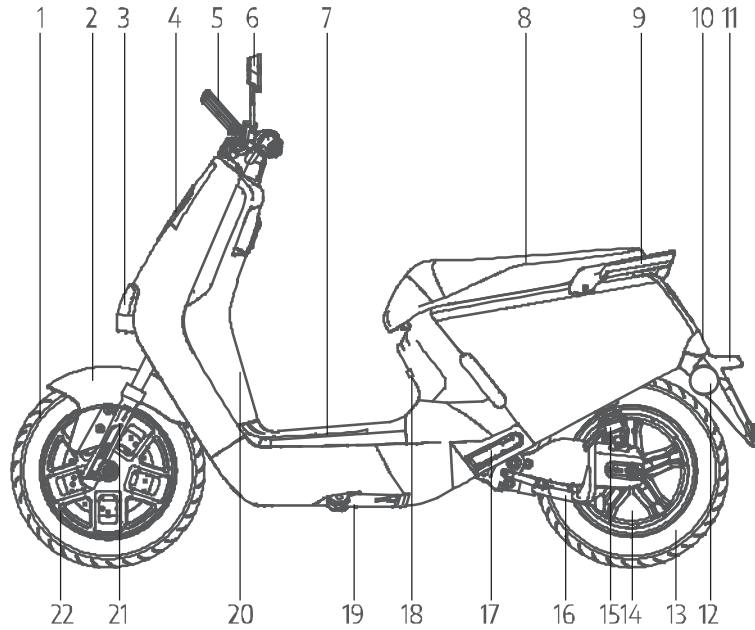

1. Front tire 2. Front fender 3. Headlight 4. LOGO light 5. Speedometer 6. Rear-view mirror 7. Batteries 8. Seat
 9. Handrail 10. Taillight 11. Rear license light (upper part) 12. Side reflectors 13. Rear wheel 14. Motor 15. Rear absorbers
 16. Main stand 17. Footrest 18. Charging hole 19. Side stand 20. VIN number 21. Front absorbers 22. Front wheel rim (lower part)

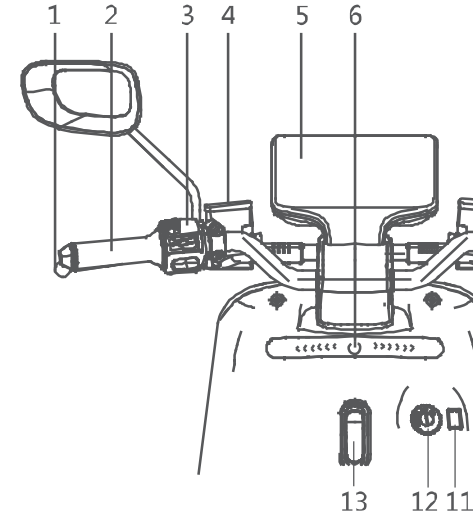

1. Left rear brake handle 2. Left handlebar 3. Left switch group 4. Left disc brake
 7. Right disc brake pump 8. Right switch group 9. Throttle 10. Right front brake
 11. Hook 12. Power lock 13. USB charging hole (lower part)

Operation Guide

Dashboard Display Info

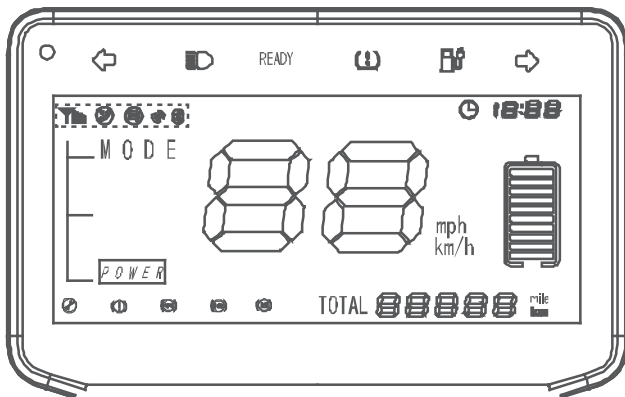

- Smart signal indication Left turning light indication M O D E Gear display High beam indication
READY Ready for operation Tyre pressure warning indication Low battery indication Right turning light indication
Clock display Speed table Odometer Motor damage indication Controller failure indication
Throttle failure indication Brake failure indication Fault alarm signal

8

Operation Guide

Power lock switch indication

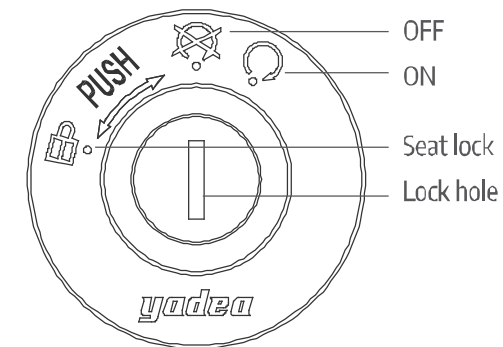

Push and rotate anticlockwise to lock the handle bar

Operation Guide

Dashboard Display Info

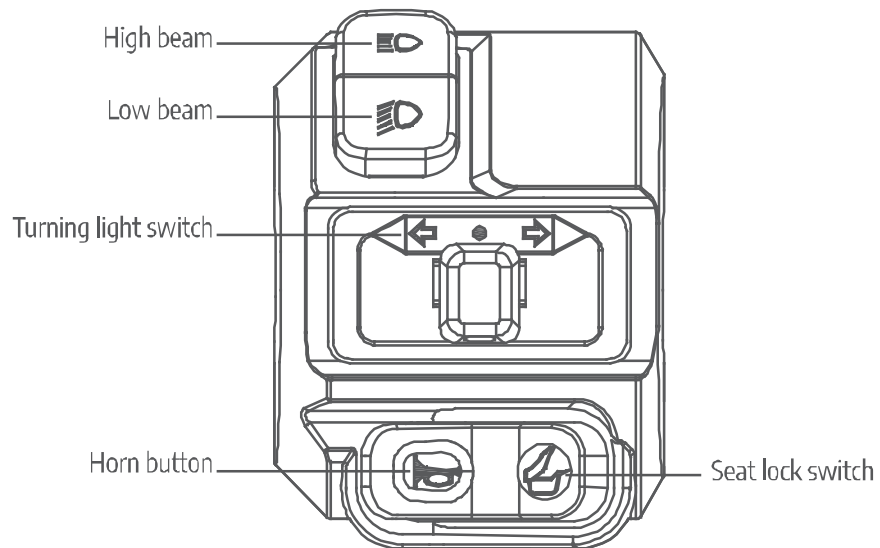

Turn left to turn on the left turning light
Turn right to turn on the right turning light
Stop in the middle is turn off the turning light

10

Operation Guide

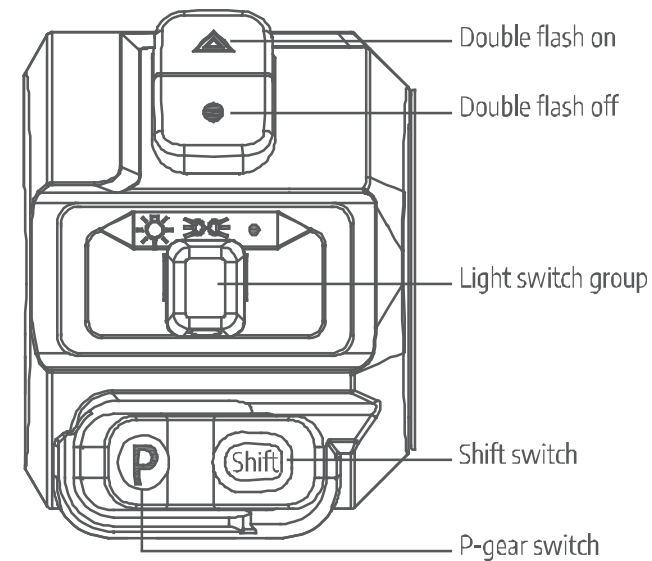

Turn left to turn on the headlight manually,
with the headlight switch in the middle, and turn right to turn

The operation mode of starting the protection function (P gear) is as follows:

Unlock the P gear: Turn on the power lock and press the P-gear switch.

When the display interface of the instrument changes from the " P" to the " GO" , the P gear is unlocked and the whole scooter can ride at this time.

Locking of P gear: when the P gear is unlocked and the scooter is not riding, press the P gear switch again and the P gear will be locked; Or if the motor stops rotating for more than 120 seconds after riding, the p gear will be locked automatically.

After the P gear is locked, the instrument display interface will change to the " P", and the whole scooter will not be able to ride at this time. If you want to ride the scooter, you need to press P gear again.

12

Operation Guide

Open seat cushion

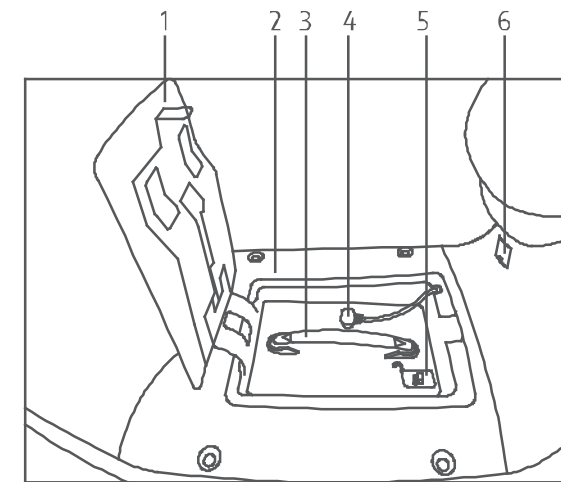

1. Battery c
2. Footplate
3. Battery h
4. Power w
5. Battery c
6. Charging

Open the seat, close the air switch. Insert the key into the lock of the battery compartment cover.

Operation Guide

Locating

1. When the scooter is completely stopped, the turning light switch turns off and the key is turned to the OFF position.
2. When parking, people stand on the left side and flat ground to step on the pedal lever of the main support, step down with force and lift up with right hand. When you leave the scooter, in order to prevent the scooter be stolen, please be sure to lock the anti-theft lock and take away the key.

Start the scooter

1. Turn the power switch to the ON position, whether all kinds of lights are on, whether all switches are working, whether the horn is ringing, and whether the gate switch is normal.
2. If there is no difference, lay down the main bracket to make the rear wheel touches the ground.
3. After seated correctly, turn on the power lock and press the p switch. when the display interface of the instrument jumps from the " p" screen to the " GO" screen, the p is unlocked and the whole vehicle can ride at this time.

Use of brake

When braking, It is recommended to brake the rear wheel before the front wheel, The effect is the best.

1. After returning the throttle quickly, hold the brake handle tightly.
2. The best way is to brake slowly and then tighten it.
3. Do not brake sharply or turn sharply. Emergency braking and sharp steering are the main factors causing sideslip or rollover, which are extremely dangerous.

Battery&Charger Use and Maintenance

Instructions for use of battery and charger

1. Charging and maintenance of batteries

This scooter uses maintenance-free lithium battery, the operating environment too low will reduce its effective capacity, too high will affect its service life, it is normal when the continuous distance after one charge is reduced. When its function will resume naturally. The battery is an important component, Please pay attention to proper protection. Please do not use the electric energy for a long time you ride. When the undervoltage indicator flashes, you must charge after riding every day, which is of great benefit to the battery life.

2. Use and maintenance of charger

- Carefully check whether the rated input voltage (AC220V) of the charger is consistent with the grid voltage.
- Pay attention to charging the battery in the open area.
- Check whether the charger output plug is loose or not. When charging, first connect the charger output plug to the battery pack charging interface, then connect the charger power plug to the household AC220V power supply, and the indicator light is red. This procedure is not allowed to reverse operation.
- When the "charging" indicator lamp is normally charged, the charging indicator lamp will show " red". When the indicator lamp shows " green", it means that the battery is fully charged, and the battery can be put into use at this time.
- Chargers and wire covers are strictly prohibited from heavy pressure to avoid short circuit.
It is forbidden to put wet rain gear and charger into the bucket in rainy days.
- The charger adopts constant current and constant voltage intelligent charging method to charge. According to the different discharge depth of the battery, the lithium battery can normally be fully charged within 5 hours.
After the battery is full, unplug the charger power plug first, then unplug the charger output plug.
- When not charging or charging is completed, be sure to unplug the charger.

Battery Use and Maintenance

Attention

The new scooter battery maybe low due to delivery, transportation, etc. Please fully charge the battery (the recommended charging time for the first time is 5 hours) before use.

If you do not use the electric scooter for a long time, please charging the battery regularly, otherwise the battery life will be seriously shortened

Don't throw away the waste batteries to avoid polluting the environment. The waste batteries shall be recycled by the distributor.

Warning:

- ▲ All operation should be strictly conform to the user manual. If not, result will be assumed by user.
- ▲ Must use original charger
- ▲ Pay attention to the type of battery and applied voltage. Mixture use is forbidden.
- ▲ Charging should be in ventilated environment. DO NOT charge in closed space or under high temperature.
DO NOT put charger into trunk or tail box while charging.
- ▲ While charging, connect battery with charger before connect with electric supply. After full charged, cut off the electric supply before cut off the battery plug.
- ▲ When the green light turns on, please cut off the power in time. Avoid long time connection between charger and AC power supply while not charging.
- ▲ While charging, if the signal light is abnormal, has different smell or the charger is over temperature, please stop charging immediately and check or change the charger in time.
- ▲ When using and storing the charger, please avoid foreign matter, especially water or other liquid in case of internal short circuit. DO NOT bring charger within scooter, if have to, please make sure of damping.
- ▲ DO NOT disassemble or change the parts in charger by yourself.

Attention:

- ▲ If the battery can not be fully charged after 12 hours, please stop charging.
- ▲ To maximize the battery life, please keep the battery percentage within 20% to 80%.
- ▲ For storage, please keep the battery under 40°C to prevent irreversible damage.
- ▲ Z3 battery will lose more capacity in lower temperature conditions.
To be more specific, the usable capacity at -10°C is 70%, 85% at 0°C and 95% at 20°C.
- ▲ The best battery capacity performance for storage is 50%. Storing battery with more than 90% over a long period of time will cause irreversible capacity loss.
- ▲ The battery needs to take out from the scooter for storage longer than 2 months, please keep the battery at the temperature of 0°C to 20°C with capacity 50%. Please have at least one cycle of charge and discharge every 2 months to minimize capacity loss.
If the battery failure is due to misuse or lack of proper maintenance as follows, please stop using it immediately.
- ▲ Falling may cause uncontrollable internal damage to the battery and may cause smoking, fire or explosion.

DOs and DON'Ts while Riding

Before Riding: Please check the following details before riding.

Check Point	Description
Steering Handlebar	1.Steadiness 2.Steering flexibility 3.No axial displacement or loosening
Braking	1. Braking lever has 5 to 9mm idle travel.
Tyres	1.The air pressure range of both tires is 25 to 34psi 2.Proper tyre tread depth 3.No cracks or openings
Battery	Adequate for planned distance to travel
Lights	Check all the lights—High Beam, Low Beam, Brake Light, Turn Signal Indicator, etc
Horn	Check whether the horn can work

DOs and DON'Ts while Riding

Braking Precautions

Adjust the scooter upright before applying brakes.

If the tyres are locked and the scooter lose steering ability resulting from e

loosen the grip on the braking lever and the tyres will be working again a

Try to maintain a 1:1 ratio of front and rear braking force on slippery roads

Attention:

Inexperienced riders tend to use the rear brake only, which will accelerate and result in a longer braking distance.

Warning:

Using the front brake or rear brake only is dangerous because of possible

Pay extra attention and use the brakes gently when riding on damp, slipp

Otherwise, riders will be exposed to great danger.

Maintenance and Repair

Users are advised to have the scooter checked and maintained on a regular basis, even for the scooters that are not used for a long time.

Regular Maintenance

Users are advised to have their scooters checked 2 months after purchased or with 500km travelled distance.

Overall check and maintenance is advised to be conducted every 6 months or 3000km thereafter. (detail as attachment)

Maintenance and Repair

		Attachment
NO	Inspetion Item	
1	Rotating the handle bar to check whether the steering parts are loose and worn	
2	Whether the pedal parts are worn and whether rotation is flexible	
3	Whether the tire pressure is properly and whether the tire is worn	
4	Whether the lamp bulb is bright	
5	Whether the brake shoe is worn or not	
6	Whether the wheel rim is deflected or deflected	
7	Whether the front fork, frame deflected	
8	Whether the fasteners are looseed	
9	Whether the brake is in good condition	
10	Whether the horn is normal	
11	Whether the charger wire is worn	
12	Head tube, rear flat fork and shock absorption which connected with the frame	
Remark: ■Check ▲Adjust ◆Reolace ●Lubrication		
Attention: For scooters used by families,the maintenance schedule shall be carried out as specified in the Pay attention to non-family scooters (e.g.business,commercial,corporate,group purchase, lea		

Daily Maintenance

If any problem occurs during checks, please look through the Home Repair Instructions or send the scooter to the dealer's for checks and maintenance.

Scooter Washing

Please use neutral detergent and water to wash the scooter. Use soft cloth to wipe the scooter after washing to prevent scratching.

Attention:

If the scooter is frequently used in overload, high-speed, bumpy or up/down, the maintenance cycle should be shortened.

For more guaranteed quality and longer service life, please use original parts.

Warning:

If incapable of repair or adjustment on his/her own, the scooter owner is advised to go to the dealer for maintenance and adjustment for the sake of safety.

Always choose a smooth surface road for repair and adjustment. If it's necessary to go to the dealer, please mind the traffic.

Warning:

Do not use pressure washer to wash the scooter, especially around the battery.

Do not flush the rear inner mudguard, where the charger, controller and other electrical components are located.

If the charging port on the scooter is wetted, please do not charge before it is completely dry.

Contacting your dealer is recommended.

Storage Method

Short-time Storage:

1. Keep the scooter in flat, steady, well-ventilated and dry area.
2. Charge the battery to 50% full before storage to maximize battery life.
3. Avoid exposure under sunlight and rain to reduce damage or aging.

Long-time Storage:

1. Remember to have a cycle of charge and a discharge at least every 2 months and charge the battery to 50% full before storage to maximize battery life.
2. Charge the battery to 100% full after long-term storage.
3. Check all the parts carefully to make sure that there is no problem before riding it. If there's any problem, take the scooter to your dealer for maintenance or repair.

Warning: Please take out the battery from the scooter when long-term storage.

Troubleshooting	
Malfunction Description	Causes
No output when switched on	1. Dead battery 2. Battery not connected
Motor failure when turning the twist grip after switched on	1. Battery voltage is low 2. The power off switch is not reset when pulling the brake 3. The Parking Mode has not been turned off yet
Battery charge failure	1. Not properly connected 2. Battery temperature is too high or too low

Technical Parameters

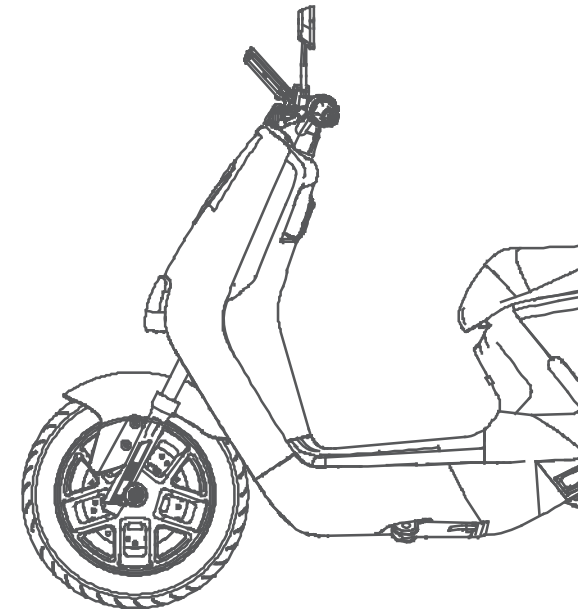

Troubleshooting List		
Malfunction Description	Causes	Troubleshooting
Dropping speed or range	1.Low battery level 2.Under-inflation of tyres 3.Frequent braking and overload 4.Battery aging or normal capacity loss 5.Low battery capacity resulting from low temperature	1.Charge the battery and check if the plug is properly plugged in and whether the charger is damaged. 2.Check the tyre inflation every time. 3.Develop good riding habits. 4.Replace the battery. 5.Normal situaiton.
Sudden stop during a ride	Dead battery	Charge the battery
	Identify the fault causes in reference to the meter panel fault codes.	

Maintenance

Dimension(mm)	1810×700×1160	Motor rated torque	≥40N·m
Wheel base(mm)	1270	Power consumption(100km)	≤2.6kw/h
Weight	86±0.5kg	Battery type	Lithium
Gradeability	15°	Battery capacity	60V26Ah
Max speed	45km/h	Charging voltage	AC110V-AC220V
Mileage(per charge)	≥50km	V _{qn}	52.5V
Rated motor speed	430±10 r/min	Charging time	4~6h
Rated voltage	60V	Controller max.Current	35±1 A
Rated efficiency	≥81%	Motor type	Brushless
Loading weight	85kg	Motor rated power	1800w

Date	Malfunction Description	Malfunction Description	Service Station

Maintenance Record

Date	Malfuntion Description	Malfuntion Description	Service Station	Serviced by	Remarks

Maintenance

Date	Malfuntion Description	Malfuntion Description	Serv